



# Invitation for Public Comment

Regarding a proposal for a new project in your neighborhood  
**Road Bank Stabilization on East Side of Avondale Road**

## Project Information

**Project Name:** Avondale Road Bank Erosion

**Description:** Repair of Avondale Road embankment by constructing a soldier pile wall adjacent to Bear Creek and modification of the creek floodplain to encourage natural flow movement away from the road. Includes stream restoration components.

**Project File #:** LAND-2021-00723 & LAND-2021-00724

**Parcel #:** SW 1/4 Section 31, Township 26N, Range 06E

**Application Type:** Type III- Shoreline Conditional Use Permit and Type II-Shoreline Substantial Development Permit

**Decision Maker:** Quasi-judicial, Hearing Examiner

**Required Permits:** Civil Construction Drawings, ROW Use Permit

**Studies:** Critical Areas Report, Tree Report, Geologic & Geotech Assessment, Hydrologic & Hydraulic Report

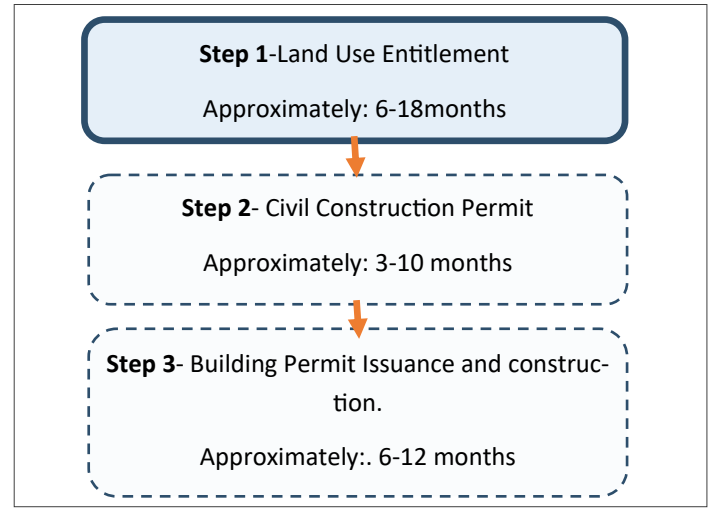

## Important Dates

Date of Application and Completeness:	September 22, 2021
Neighborhood Meeting Date:	TBD, separate notice will be issued
Date Comments Due by:	November 1, 2021
Public Hearing	To Be Determined

***\*Please see the reverse side for Public Comment and Contact Information\****

## Vicinity Map

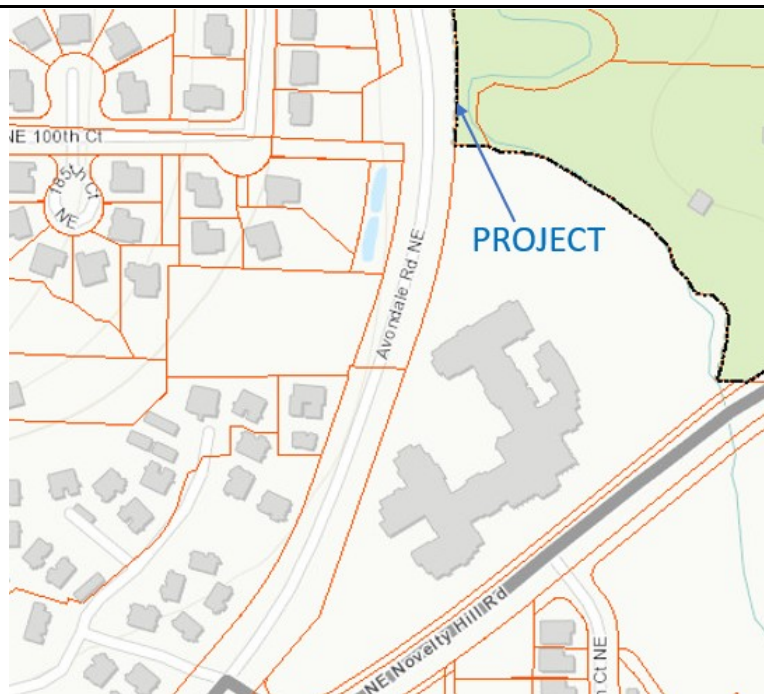

# Avondale Road Bank Erosion

LAND-2021-00723 & LAND-2021-00724



For more information, go to [redmond.gov/Projects](http://redmond.gov/Projects) and select by project name.

## Project Contact Information

Planner: Cathy Beam, AICP	<a href="mailto:cbeam@redmond.gov">cbeam@redmond.gov</a>	425-556-2429
Project Applicant: Emily Flanagan, PE	<a href="mailto:eflanagan@redmond.gov">eflanagan@redmond.gov</a>	425-556-2707

## When can I submit a comment?

Although comments are accepted up until decision is issued, submittal of comments during the comment period required in the Redmond Zoning Code (RZC) will ensure comments are considered prior to issuing a decision and will allow staff and/or the applicant to address comments as early in the process as possible.

The Technical Committee shall not issue a recommendation until the end of the minimum comment period.

## How do I stay updated on decisions?

If you would like to be informed of future actions you can be placed on the mailing list for this proposal by providing your **name** and **mailing address** to the project planner.

The final decision on this proposal may be appealed by individuals who provided comments according to the City appeal provision specified in RZC Chapter 21.76, Review Procedures.

## How do I submit a comment?

**By E-mail:** [cbeam@redmond.gov](mailto:cbeam@redmond.gov)

**By Mail:** Development Services Center

**In Person:** Customer Service Desk

P.O. Box 97010

Attn: Cathy Beam

Mail Stop 4SPL

15670 NE 85th Street

Redmond, WA 98073-9710

Redmond, WA 98052

---

## Public Comments on *LAND-2021-00723 & LAND-2021-00724*

Attention: Cathy Beam

---

---

---

---

---

---

---

---

---

---

*Would you like to be placed on the mailing list? If so, please complete the information below:*

Full Name: \_\_\_\_\_ Mailing Address: \_\_\_\_\_