

September 6, 2021

To: Residents, Property Owners, and Interested Parties

Subject: Virtual neighborhood meeting on proposed project –
PSR Short Plat - LAND-2021-00496

Join us at a virtual neighborhood meeting to discuss PSR Short Plat. This meeting will be held prior to the City of Redmond making a decision on the project. We'd like you to review the proposed project, ask questions and provide your input at the virtual neighborhood meeting. Please refer to the attached vicinity map for the project location.

Meeting Details:

Monday, September 27, 2021
6:00-7:00 p.m.
Via Zoom

Visit <https://www.redmond.gov/1619/PSR-Short-Plat> for the link to join the online meeting
Or call 1-253-215-8782, Meeting ID: 820 6345 4001, Passcode: 896644

The meeting will be recorded and posted on the project page at the link above.
Public comments are due October 18, 2021.

Given the current public health guidelines about the coronavirus (COVID-19), we're conducting this meeting online to ensure the health and safety of staff and residents. Thank you for your flexibility during this unprecedented time. Our goal is to ensure your safety while providing a forum for interested individuals to engage with the applicant and the City to learn about the proposal and ask questions early in the review process.

Applicant: Prasadth Thiruveedu; (425)753-6567, prasadth@gmail.com

Project Location: 5109 154th Ave NE, Redmond, WA 98052 – 3882320060, in the R-5 Zone in the Overlake neighborhood.

Project Description: Demolish existing single-family home subdivide the property into seven single family lots.

If you would like to be added to the interested party list (which helps you stay informed throughout the review of this project) or if you have any questions about this project or attending the virtual neighborhood meeting, please contact:

Cameron Zapata, Senior Planner
425-556-2411
czapata@redmond.gov

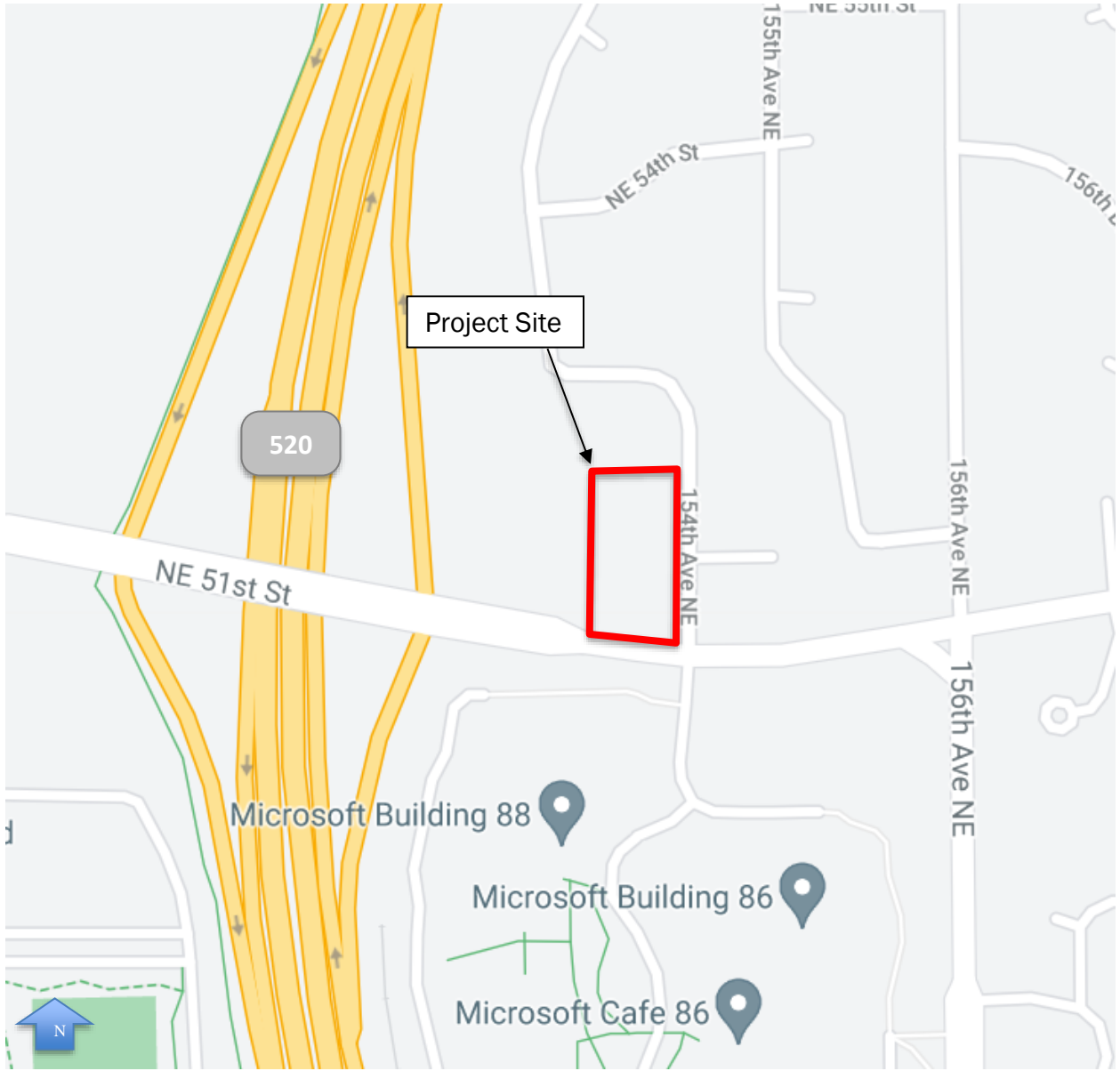

Project Site

520

NE 51st St

NE 54th St

155th Ave NE

NE 55th St

156th Ave NE

154th Ave NE

156th Ave NE

156th Ave NE

Microsoft Building 88

Microsoft Building 86

Microsoft Cafe 86

