

McKay Overlake Rezone; L030055

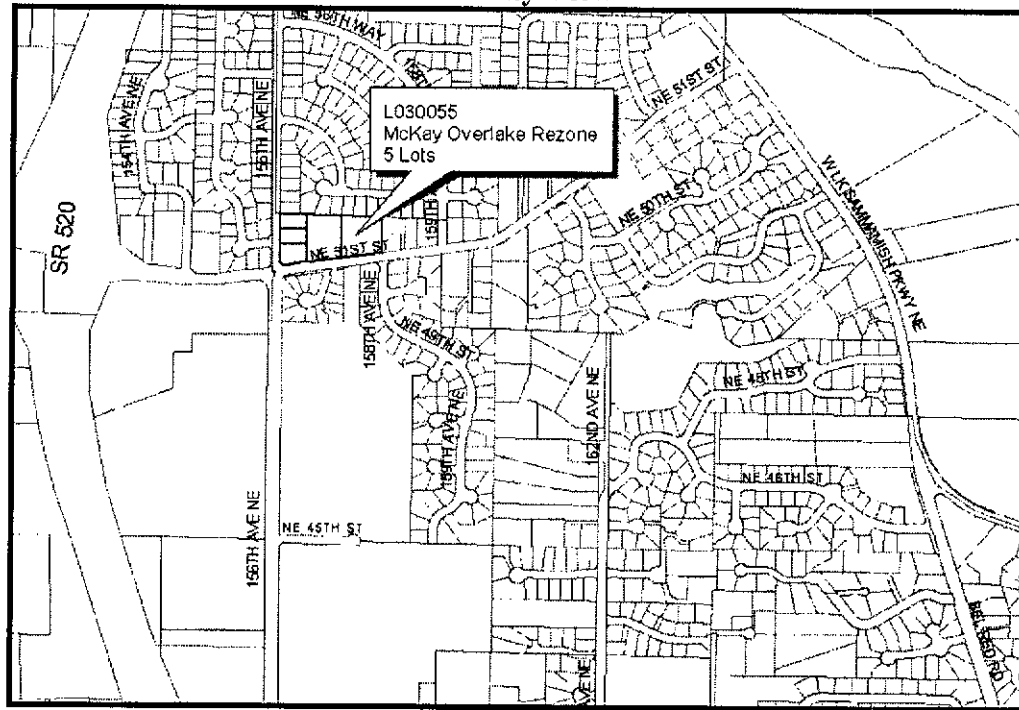

McKay Overlake Rezone; L030055
King County Tax I.D./Parcel Numbers



Concomitant Zoning Language

For development of ten (10) or more residential units, whether as part of a phased or not phased development, a minimum of 10% of the units shall be made affordable to households earning 80% or less of the King County Median Income, adjusted for household size. A bonus density of one (1) unit shall be allowed for each affordable unit provided, up to 15 percent above the maximum density permitted on the site. Prior to issuance of any building permits for developments consisting of ten (1) or more units, an agreement in a form approved by the City shall be recorded with the King County Department of Records and Elections to stipulate conditions under which the required affordable unit(s) will remain affordable housing for the life of the project. This agreement shall be a covenant running with the land, binding on the assigns, heirs, and successors of the applicant. The City may agree, at its sole discretion to subordinate any affordable housing regulatory agreement for the purpose of allowing the owner to obtain financing for development of the property, consistent with any applicable provision of the Community Development Guide in effect at the time of the issuance of the building permit.

Legal Description

Parcel Number: 142505-9107
Address: 5220 156th AVE NE, Redmond, WA
Q-S-T-R: NE-14-25-5
Legal Description: N 91.5 FT OF W 185 FT OF S 1/2 OF SW 1/4 OF NE 1/4 LESS CO RD

Parcel Number: 142505-9081
Address: 5208 156th AVE NE, Redmond, WA
Q-S-T-R: NE-14-25-5
Legal Description: S 91.5 FT OF N 183 FT OF W 185 FT OF S 1/2 OF SW 1/4 OF NE 1/4
LESS CO RD

Parcel Number: 142505-9091
Address: 15604 NE 51ST ST, Redmond, WA
Q-S-T-R: NE-14-25-5
Legal Description: POR OF E 155 FT OF W 185 FT OF S 1/2 OF SW 1/4 OF NE 1/4 LY
NLY OF CO RD LESS N 183 FT LESS POR DEDED TO CITY OF
REDMOND #8402060279

Parcel Number: 142505-9080
Address: 15628 NE 51ST ST, Redmond, WA
Q-S-T-R: NE-14-25-5
Legal Description: E 210 FT OF W 395 FT OF POR OF S 1/2 OF SW 1/4 OF NE 1/4 LY
NLY OF CO RD

Parcel Number: 142505-9047
Address: 15660 NE 51ST ST, Redmond, WA
Q-S-T-R: NE-14-25-5
Legal Description: E 245 FT OF W 640 FT OF POR OF S 1/2 OF SW 1/4 OF NE 1/4 LY
NLY OF CO RD