



Invitation for Public Comment

Regarding a proposal for a new project in your neighborhood

at 16701 Cleveland St, Redmond, WA 98052.

Project Information

Project Name:	ST DRLE Downtown Station
Description:	Downtown light rail station to complete a 3.4 mile light rail extension. Project includes station, plaza, landscaping, and associated site improvements.
Project File #:	LAND-2020-00181
Parcel #:	122505-9082
Application Type:	Type II—Site Plan Entitlement
Decision Maker:	Administrative, Technical Committee
Required Permits:	SEPA, Building Permits, ROW, Civil Construction, Utility
Studies:	Level II Hydrogeology, Tree Health Report, Geotechnical, Critical Areas Report



Important Dates

Date of Application and Completeness:	February 6, 2020
Neighborhood Meeting Date:	Not Applicable
Notice of Application Comments Due By:	March 13, 2020

Please see the **reverse side for Public Comment and Contact Information**

Preliminary Site Plan

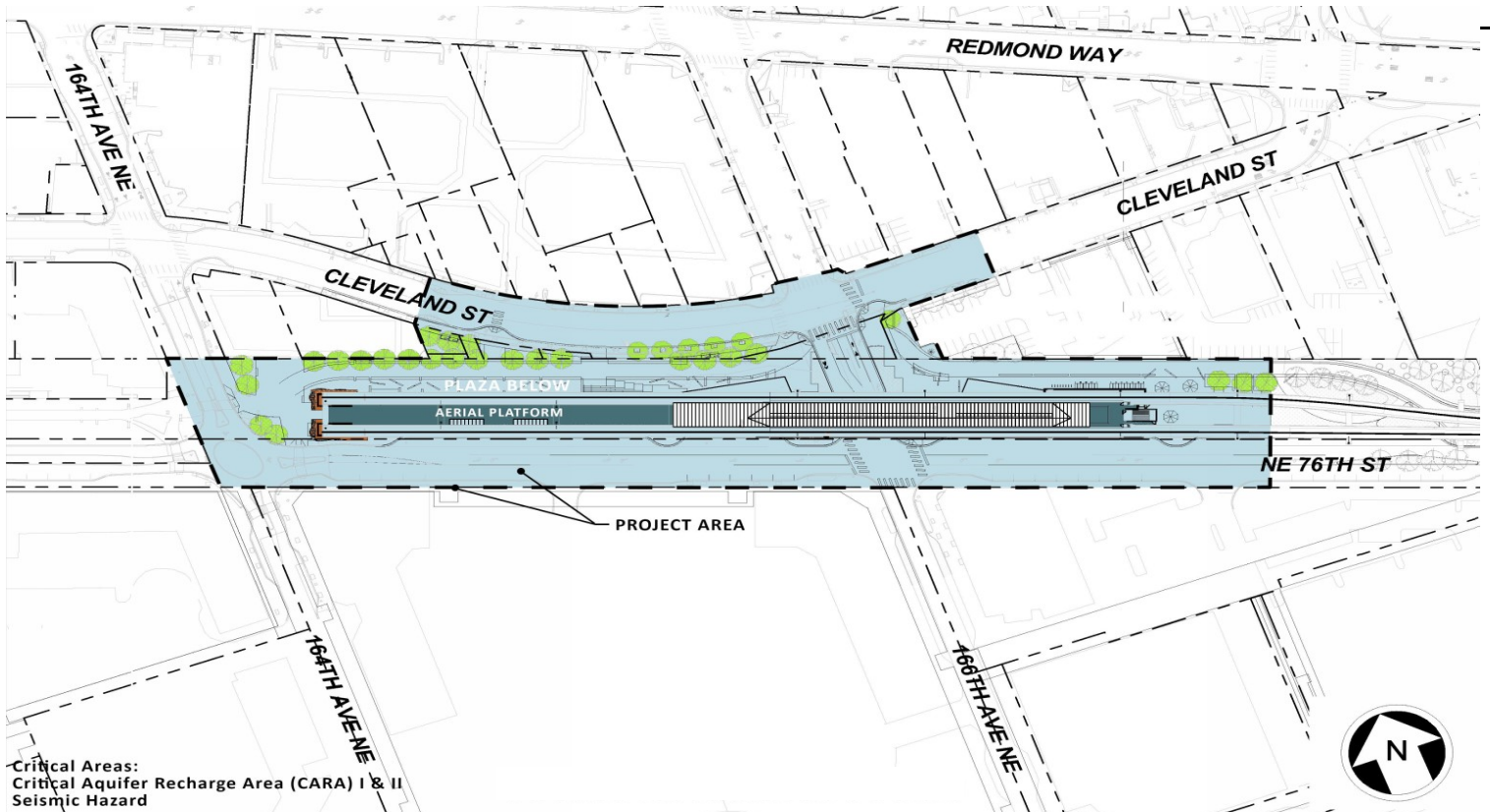

Critical Areas:
Critical Aquifer Recharge Area (CARA) I & II
Seismic Hazard



ST DRLE Downtown Station

LAND-2020-00181

For more information, go to redmond.gov/Projects and select by project name.

Project Contact Information

Planner: David Lee, Principal Planner	dlee@redmond.gov	425-556-2462
Project Applicant: Bryan Williams, SWK	bwilliams@swkjv.com	206-715-8419

When can I submit a comment?

Although comments are accepted up until decision is issued, submittal of comments during the comment period required in the Redmond Zoning Code (RZC) will ensure comments are considered prior to issuing a decision and will allow staff and/or the applicant to address comments as early in the process as possible.

The Technical Committee shall not issue a decision until the end of the minimum comment period.

How do I stay updated on decisions?

If you would like to be informed of future actions you can be placed on the mailing list for this proposal by providing your **name** and **mailing address** to the project planner.

The final decision on this proposal may be appealed by individuals who provided comments according to the City appeal provision specified in RZC Chapter 21.76, Review Procedures.

How do I submit a comment?

By E-mail: dlee@redmond.gov

In Person: Customer Service Desk

Attn: David Lee, Principal Planner
15670 NE 85th Street
Redmond, WA 98052

By Mail: Development Services Center

P.O. Box 97010
Mail Stop 4SPL
Redmond, WA 98073-9710

Public Comments on LAND-2020-00181

Attention: *David Lee, Principal Planner*

Would you like to be placed on the mailing list? If so, please complete the information below:

Full Name: _____ Mailing Address: _____