



Invitation for Public Comment

Regarding a proposal for a new project in your neighborhood
at 7960, 7970, 7980 170th Ave NE, Redmond, WA 98052.

Project Information

Project Name: Penny Lane II

Description: **Construct** 14 townhomes within one building
Subdivide each townhome to enable individual sale

Project File #: LAND-2019-00399 and LAND-2019-00400

Parcel #: 7792900140; 7792900130; 7792900125

Application Type: Type III- Subdivision
Type II-Site Plan Entitlement

Decision Maker: Quasi-judicial, Hearing Examiner

Required Permits: SEPA, Building, ROW, Civil Construction, and Utility

Studies: Critical Areas Aquifer Recharge Report, Critical Areas Report, Cultural Resources Report, Geotechnical Report, Stormwater Report, Traffic Study Report, Tree Preservation Plan, Tree Health Assessment



Important Dates

Date of Application and Completeness:	January 15, 2020
Neighborhood Meeting Date:	February 24, 2020 separate notice to follow
Date Comments Due by:	February 19, 2020
Public Hearing:	To Be Determined, separate notice to follow

****Please see the reverse side for Public Comment and Contact Information****

Vicinity Map

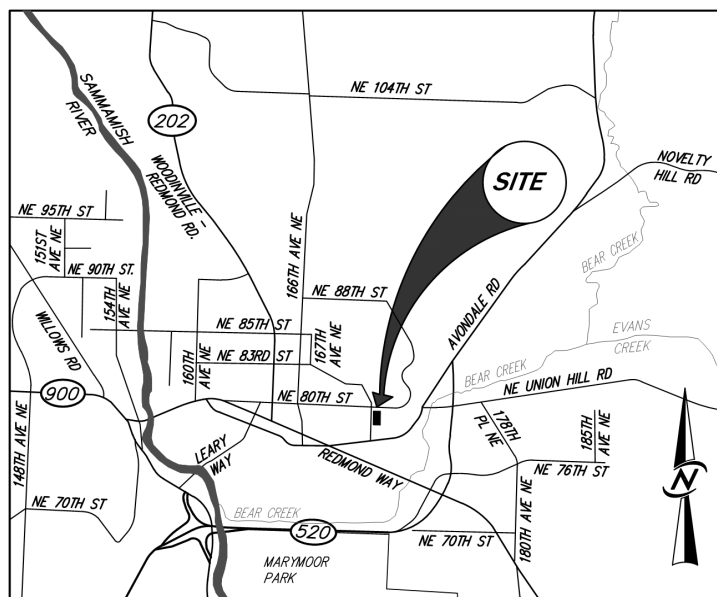

SITE VICINITY MAP

1" = 2,000'



For more information, go to redmond.gov/Projects and select by project name.

Project Contact Information

Planner: Elise Keim	ekeim@redmond.gov	425-556-2480
Project Applicant: Randy Barnett	randy@ichijousa.com	425-497-0616

When can I submit a comment?

Although comments are accepted up until decision is issued, submittal of comments during the comment period required in the Redmond Zoning Code (RZC) will ensure comments are considered prior to issuing a decision and will allow staff and/or the applicant to address comments as early in the process as possible.

The Technical Committee shall not issue a recommendation until the end of the minimum comment period.

How do I stay updated on decisions?

If you would like to be informed of future actions you can be placed on the mailing list for this proposal by providing your **name** and **mailing address** to the project planner.

The final decision on this proposal may be appealed by individuals who provided comments according to the City appeal provision specified in RZC Chapter 21.76, Review Procedures.

How do I submit a comment?

By E-mail: ekeim@redmond.gov

By Mail: Development Services Center

In Person: Customer Service Desk

P.O. Box 97010

Attn: Elise Keim

Mail Stop 4SPL

15670 NE 85th Street

Redmond, WA 98073-9710

Redmond, WA 98052

Public Comments on *LAND-2019-00399 & LAND-2019-00400*

Attention: Elise Keim

Would you like to be placed on the mailing list? If so, please complete the information below:

Full Name: _____ Mailing Address: _____



Preliminary Tree Preservation and Site Plan

Penny Lane II

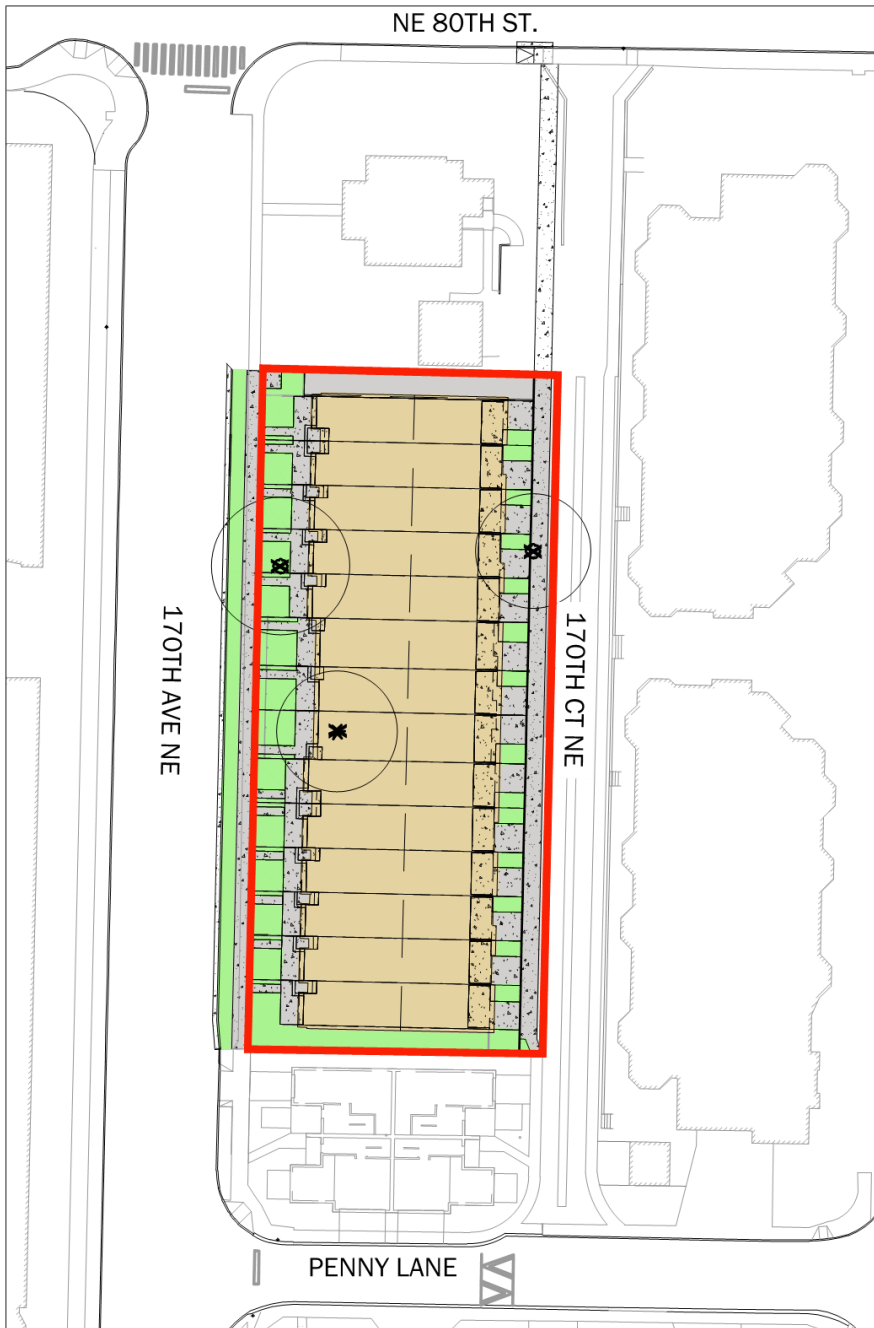

LAND-2019-00399

LAND-2019-00400



PENNY LANE II SITE LAYOUT

LEGEND

-  BUILDING
-  LANDSCAPING
-  PAVEMENT
-  SITE BOUNDARY
-  REMOVED TREE

