

RESOLUTION NO. 1218

A RESOLUTION OF THE CITY OF REDMOND, WASHINGTON, RESOLVING TO ADJUST THE BOUNDARY LINE BETWEEN THE CITY OF REDMOND AND THE CITY OF BELLEVUE, PURSUANT TO RCW 35.10.217, ET SEQ., A PORTION OF LOT 1 OF LOT LINE REVISION, LLR 95-010, BELONGING TO MICROSOFT CORPORATION AND LOCATED ON THE SOUTHERNMOST PORTION OF ITS REDMOND CAMPUS.

WHEREAS, RCW 35.10.217 authorizes the adjustment of the boundaries of two cities by resolution of both affected cities; and

WHEREAS, such a resolution was passed by the City of Bellevue on the 20th of June, 2005; and

WHEREAS, a boundary line adjustment under RCW 35.10.217 is not subject to the State Environmental Policy Act; and

WHEREAS, the Boundary Review Board for King County approved such action; and

THE CITY COUNCIL OF THE CITY OF REDMOND, WASHINGTON, HEREBY RESOLVES AS FOLLOWS:

Section 1. Annexation. Pursuant to RCW 35.10.217, the boundary line between the City of Bellevue and the City of Redmond is hereby adjusted so as to include within the corporate boundaries of the City of Redmond a portion of Lot 1 of lot line

revision, LLR 95-010, legally described in Exhibit 1 and depicted on a map, Exhibit 2, attached hereto and incorporated herein by this reference as if set forth in full.

RESOLVED THIS 6th day of December, 2005.

CITY OF REDMOND

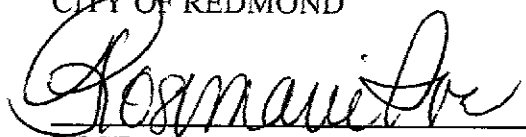

ROSEMARIE IVES, MAYOR

ATTEST/AUTHENTICATED:

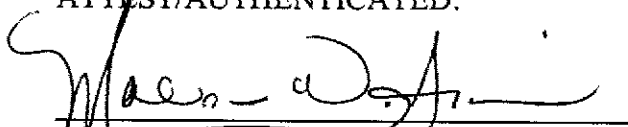

MALISA FILES, CITY CLERK

FILED WITH THE CITY CLERK:	November 28, 2005
PASSED BY THE CITY COUNCIL:	December 6, 2005
SIGNED BY THE MAYOR:	December 6, 2005
EFFECTIVE DATE:	December 6, 2005
RESOLUTION NO. <u>1218</u>	

EXHIBIT 1 to Resolution No. 1218

Legal Description for Boundary Adjustment between the City of Redmond and the City of Bellevue.

That portion of the Southeast quarter of the Northwest quarter of the Southeast quarter of Section 23, Township 25 North, Range 5 East, W.M., in King County, Washington, described as follows:

Beginning at the Southwest corner of said subdivision and a point on the Redmond city limits, as established by City of Redmond Ordinance No. 1764; thence Northerly along the West line of said subdivision and Redmond city limits 106.45 feet; thence Easterly along said Redmond city limits to a point on a line 30.00 feet Northwesterly and parallel with the centerline of Bellevue-Redmond Road, as measured at right angles to said centerline and lying 170.00 feet Northeasterly of the intersection of said parallel line with the South line of said subdivision; thence Southwesterly along said parallel line to the South line of said subdivision; thence Westerly along said South line to the Point of Beginning; Except the South 30.00 feet thereof; And Except that portion deeded to the City of Redmond by deed filed under Recording No. 8905250755.

Boundary Adjustment between the City of Redmond and the City of Bellevue

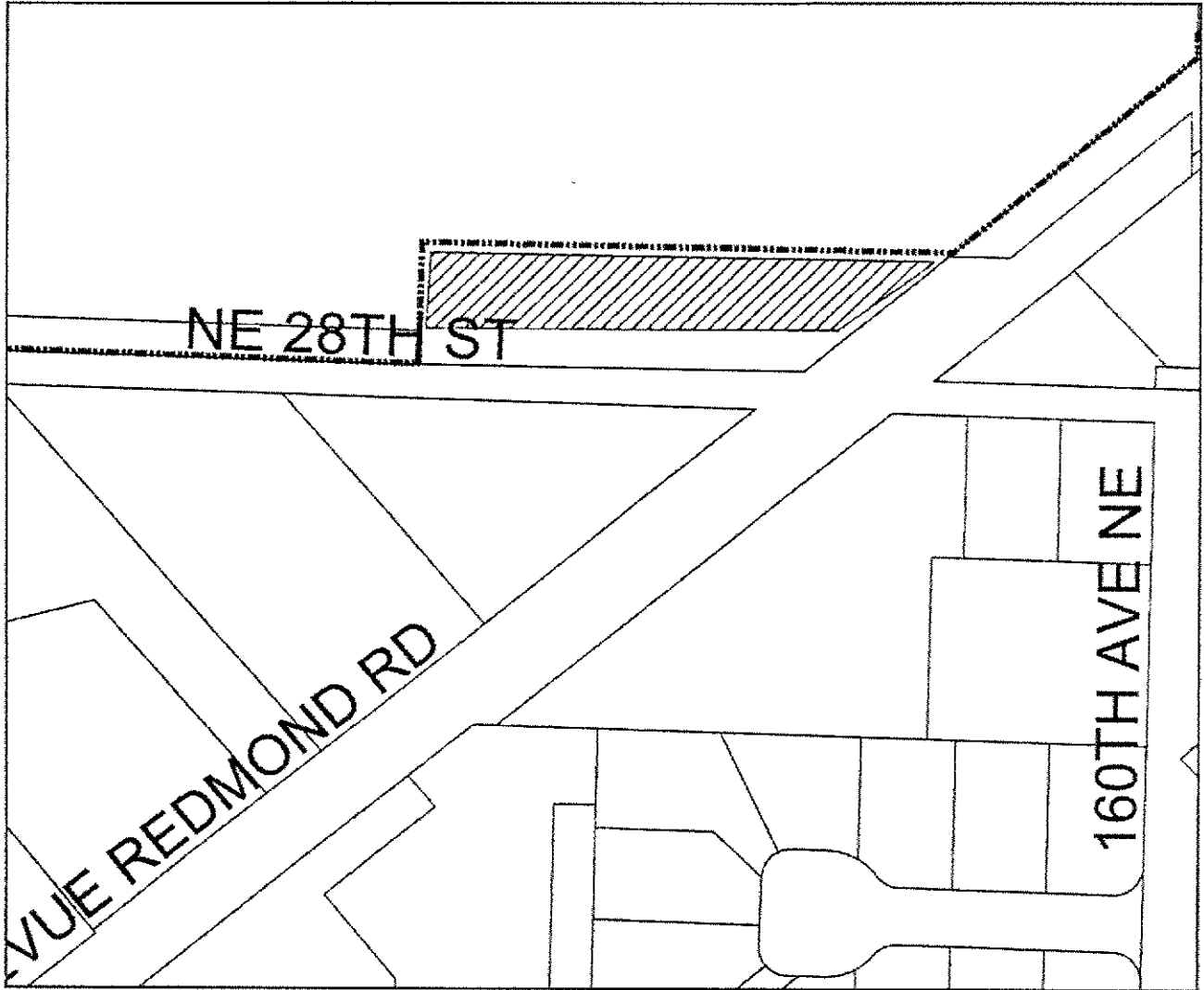

Current Redmond City Limit

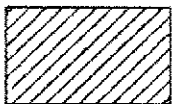

Area to be Annexed



Resolution No. 1218

Exhibit 2